

145

Standard Set Open Space, 2 Tables, Stacks of Chairs
Max Capacities Lecture - <b>138</b> Classroom - <b>66</b> Banquet - <b>96</b> Seminar - <b>60</b> Exhibit - <b>20 Tables</b> Conference - <b>54</b> U-Shaped Conference - <b>41</b>
Scale 1 inch = 8 feet 
Area Square Feet 1,700
Meeting Room AV Built-In PA (up to 2 wired mics*), Computer Audio Cable, Data Projector w/Screen, Whiteboard *Mics must be requested in advance
Contact HUB Event & Information Services Box 352230 (206)543.8191 hubres@uw.edu <a href="http://depts.washington.edu/thehub/">http://depts.washington.edu/thehub/</a>

Department/Organization --	Event Name --	Res # --	Event Date(s) --
A/V & Equipment --	Setup Notes --		
File Saved As 145_SEM.60		Version --	Date Updated --

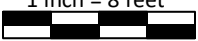
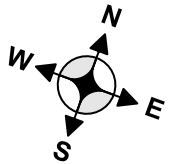
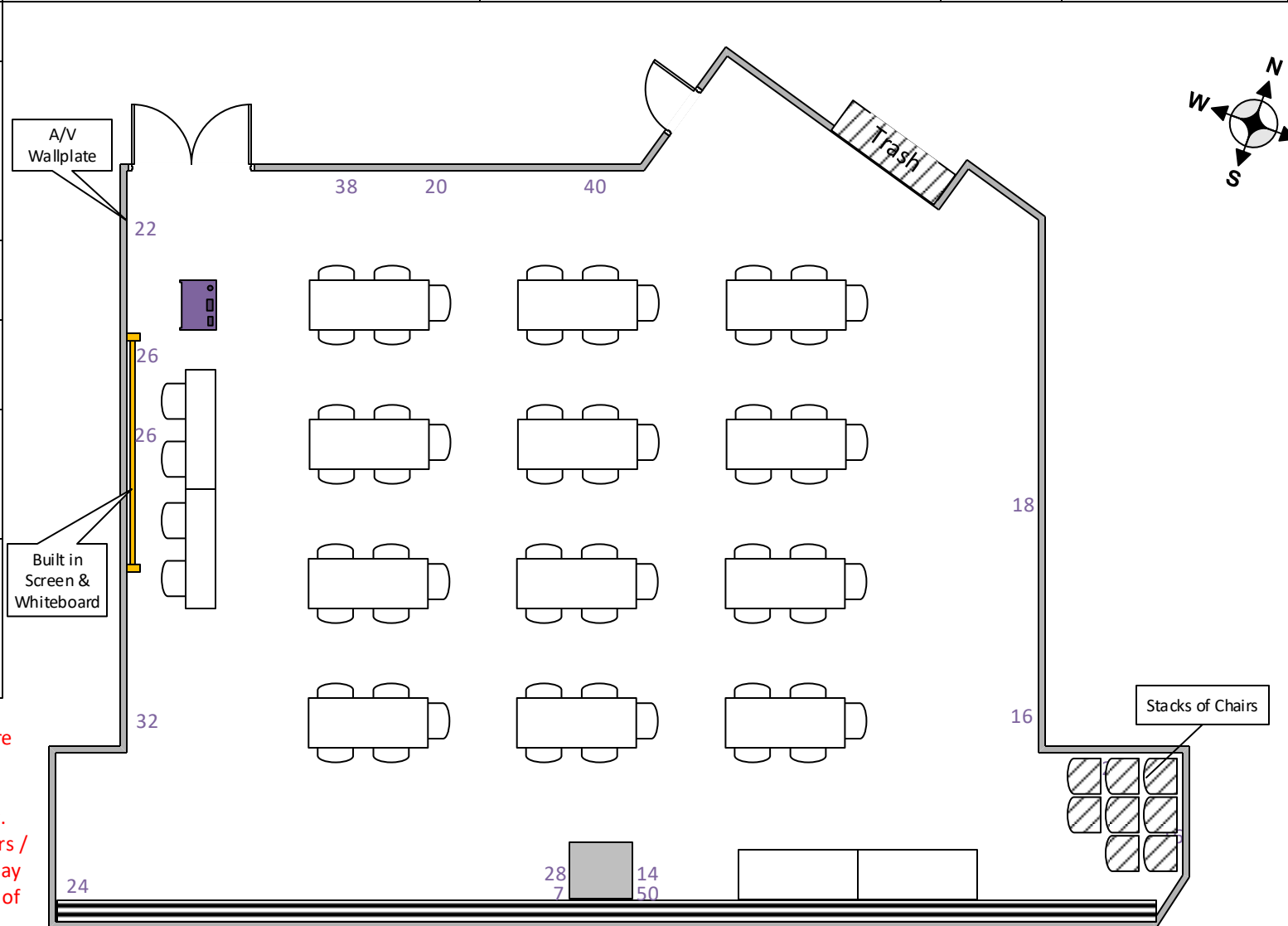

All components of the diagrams are subject to change.  
Illustrated diagrams and their components are estimations only.  
Additional furnishing (stacks of chairs / tables) not indicated on diagram may be present in the room at the time of your reservation  
Please contact our office with any additional questions.

Please sign below and return by listed due date on your confirmation. Only first contact's signature will be accepted.

Signature: \_\_\_\_\_ Date: \_\_\_\_\_

*By signing this diagram, you agree to this setup. Changes on the day of event MAY not be possible.  
All exits and hallways must remain clear and unblocked.*