

145

Standard Set  
 Open Space, 2 Tables, Stacks of Chairs

Max Capacities Lecture - **138**  
 Classroom - **66**  
 Banquet - **96**  
 Seminar - **60**  
 Exhibit - **20 Tables**  
 Conference - **54**  
 U-Shaped Conference - **41**

Scale  
 1 inch = 8 feet

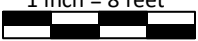

Area  
 Square Feet  
 1,700

Meeting Room AV  
 Built-In PA (up to 2 wired mics\*),  
 Computer Audio Cable, Data Projector  
 w/Screen, Whiteboard  
 \*Mics must be requested in advance

Contact  
 HUB Event & Information Services  
 Box 352230  
 (206)543.8191  
 hubres@uw.edu  
<http://depts.washington.edu/thehub/>

Department/Organization --	Event Name --	Res # --	Event Date(s) --
A/V & Equipment See "Meeting Room AV" below	Setup Notes --		
File Saved As 145_CF.54	Version --	Date Updated --	

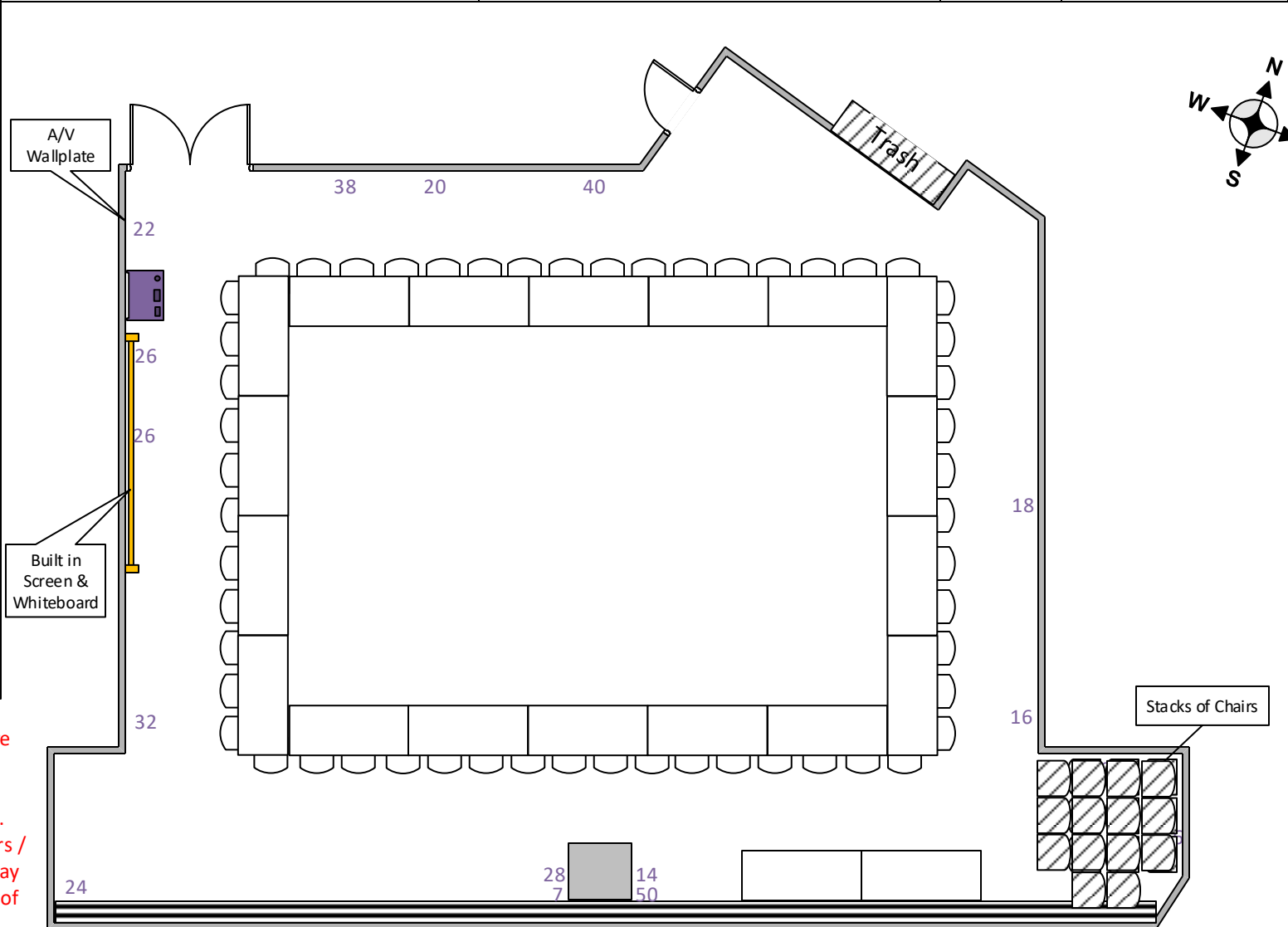

All components of the diagrams are subject to change.  
 Illustrated diagrams and their components are estimations only.  
 Additional furnishing (stacks of chairs / tables) not indicated on diagram may be present in the room at the time of your reservation  
 Please contact our office with any additional questions.

Please sign below and return by listed due date on your confirmation. Only first contact's signature will be accepted.

Signature: \_\_\_\_\_ Date: \_\_\_\_\_

*By signing this diagram, you agree to this setup. Changes on the day of event MAY not be possible.  
 All exits and hallways must remain clear and unblocked.*